

TUBE AND CLAMP

Steel Tube with Fittings



DESCRIPTION	WEIGHT
4' Tube with End Fitting	9.8 lbs
6' Tube with End Fitting	13 lbs
8' Tube with End Fitting	17 lbs
10' Tube with End Fitting	21 lbs
13' Tube with End Fitting	25 lbs

Engineering Specifications

Available in hot-dip galvanized or black
 49 mm (1.9") outside diameter by 3.18 mm (0.125") wall

Outside Diameter	49 mm	1.90 in
Wall Thickness	3.18 mm	.125 in
Yield Strength	345 mpa	50,000 psi
Ultimate Strength	483 mpa	70,000 psi
Area	451 mm ²	.699 in ²
Moment of Inertia	115296 mm ⁴	.277 in ⁴
Section Modulus	4768 mm ³	.291 in ³
Radius of Gyration	16 mm	.630 in

Bolt Clamps-Dual Purpose

- Drop forged clamps available in I-Bolt or T-Bolt

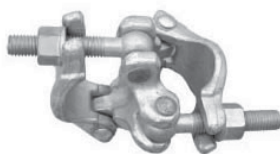

Right Angle
3.5 lbs

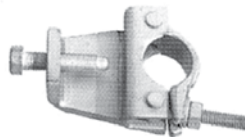

Beam Clamp
3.15 lbs



Swivel
3.5 lbs



*custom sizes available upon request

TUBE AND CLAMP

Wedge Clamps



Right Angle Clamp



Swivel Clamp



End-to-End Joiner

DESCRIPTION	SIZE	WEIGHT:metric	WEIGHT:imperial
RA Clamp (tube to tube)	2" x 2"	1.45 kg	3.3 lbs
SW Clamp (tube to tube)	2" x 2"	1.45 kg	3.3 lbs
RA Clamp (tube to frame)	2" x 1.625"	1.45 kg	3.3 lbs
SW Clamp (tube to frame)	2" x 1.625"	1.45 kg	3.3 lbs
RA Clamp (frame to frame)	1.625" x 1.625"	1.45 kg	3.3 lbs
SW Clamp (frame to frame)	1.625" x 1.625"	1.45 kg	3.3 lbs
Half SW Wedge Clamp	all sizes	all sizes	all sizes
Joiner Clamp	2" x 2"	1.45 kg	3.3 lbs

Engineering Specifications

RIGHT ANGLE CLAMP

Tube Size: 1.69" O.D.
1.90" O.D.
2.375" O.D.

SWIVEL CLAMP

Tube Size: 1.69" O.D.
1.90" O.D.
2.375" O.D.

In addition 1.90" / 1.625"
Center pin shear load 6,000 lbs

TEST RESULTS FOR 1.90" X 1.90" CLAMP

Right Angle: 2,500 lbs @ 4:1 S.F.
Swivel: 1,500 lbs @ 4:1 S.F.

- Wedge travel: approximately 3/4 length of wedge
- Galvanized finish
- No loose parts to lose or drop
- Quick intall and dismantle
- The only tool needed is a hammer
- Little or no maintenance required

NOTE:

- Use right angle couplers on primary load bearing members, such as vertical or horizontal members
- Use swivel couplers on secondary non load bearing members, such as diagonal bracing members

TUBE AND CLAMP

Aluminum Scaffold Tube



DESCRIPTION	SIZE		WEIGHT	
	metric	imperial	metric	imperial
Aluminum Tube	.61 m	2'	.82 kg	1.8 lbs
Aluminum Tube	1.22 m	4'	1.64 kg	3.6 lbs
Aluminum Tube	1.52 m	5'	2.05 kg	4.5 lbs
Aluminum Tube	1.83 m	6'	2.46 kg	5.4 lbs
Aluminum Tube	2.13 m	7'	2.86 kg	6.3 lbs
Aluminum Tube	2.44 m	8'	3.27 kg	7.2 lbs
Aluminum Tube	3.05 m	10'	4.09 kg	9 lbs
Aluminum Tube	3.66 m	12'	4.91 kg	10.8 lbs
Aluminum Tube	4.27 m	14'	5.73 kg	12.6 lbs
Aluminum Tube	4.57 m	15'	6.14 kg	13.5 lbs
Aluminum Tube	4.88 m	16'	6.55 kg	14.4 lbs
Aluminum Tube	5.49 m	18'	7.36 kg	16.2 lbs
Aluminum Tube	6.10 m	20'	8.18 kg	18 lbs

Engineering Specifications

Available in 49mm (1.9") outside diameter or by 37mm (schedule 40) wall

SCHEDULE 40 SPECIFICATIONS

Outside Diameter	49 mm	1.90 in
Wall Thickness	3.7 mm	.145 in
Yield Strength	255 mpa	37,000 psi
Ultimate Strength	300 mpa	44,000 psi
Area	515 mm ²	.799 in ²
Moment of Inertia	12931 mm ⁴	.310 in ⁴
Section Modulus	5342 mm ³	.326 in ³
Radius of Gyration	15.82 mm	.623 in